

## PRODUKTDATENBLATT PL-CUBE-AC-G3 -1100-830

PrevaLED® Cube AC G3 | Light Engines und Module für Strahler, Downlights und Wandleuchten



### Anwendungsgebiete

- Suitable for diffuser and reflector luminaires
- Hospitality, hotels, restaurants
- Public and commercial buildings
- Offices
- Secondary rooms, garages, storerooms, cellars

### Produktvorteile

- Enables low-cost and compact luminaire designs
- Low profile
- Future-proof dimensions for reliable designs
- Near Lambertian light distribution at 110° beam angle for high quality of light
- Protection against overheating due to thermal derating
- 5 year guarantee

### Produkteigenschaften

- Mains voltage driven LED engine
- Integrated control gear
- Diameter of light emitting surface: 61 mm
- Common mechanic and photometric interfaces



- Initial color consistency: < 3 SDCM
- Lifetime (L70/B50): 50,000 h (temperature at  $T_c = 70\text{ °C}$ )
- LED module is reinforced isolated to mounting surface
- Photobiological safety according to IEC/TR 62778, risk group RG1

---

## TECHNISCHE DATEN

### Elektrische Daten

Nennleistung	11,30 W
Bemessungsleistung	11.30 W
Nennspannung	230 V
Eingangsspannungsbereich	220...240 V
Stromart	Wechselstrom (AC)
Nennstrom	50 mA
Netzleistungsfaktor $\lambda$	> 0,90

### Photometrische Daten

Nutzbarer Gesamtlichtstrom	1100 lm
Lichtausbeute	97 lm/W
Lichtstrom	603 lm
Lichtstärke	403 cd
Nennnutzlichtstrom 120°	879 lm
Farbtemperatur	3000 K
Farbwiedergabeindex Ra	80
Standardabweichung des Farbgleichs	$\leq 3$ sdc
Bemessungsspitzenlichtstärke	403 cd
Lichtstromerhalt am Ende der Nennlebensdauer	0.70

### Lichttechnische Daten

Ausstrahlungswinkel	110 °
Bemessungshalbwertswinkel	110.00 °
Startzeit	< 1.0 s
Aufwärmzeit (60 %)	< 2.00 s

### LED MODULE INFORMATION

Anzahl LED je Modul	1
---------------------	---

### Maße & Gewicht

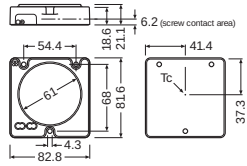

Länge	82.80 mm <sup>1)</sup>
Breite	81.60 mm
Breite (einschließlich runde Leuchten)	81.60 mm
Höhe	21.10 mm
Länge (einschließlich runde Leuchten)	21.10 mm
Produktgewicht	59,4 g

<sup>1)</sup> general tolerances ISO 2768-c

### Farben & Materialien

Produktfarbe	Weiß
--------------	------

### Temperaturen & Betriebsbedingungen

Umgebungstemperaturbereich	-20...+50 °C
Maximale Temperatur am Messpunkt tc	90 °C
Betriebstemperatur nach IEC 62717	70 °C

### Lebensdauer

Anzahl der Schaltzyklen	100000
-------------------------	--------

### Zusätzliche Produktdaten

Maximale thermische Belastung	9,7 W
-------------------------------	-------

### Einsatzmöglichkeiten

Dimmbar	Nein
DIM-Schnittstelle	DALI

### Zertifikate & Standards

Normen	CE / ENEC / CB VDE
Schutzart	IP20
Energieverbrauch	11.60 kWh/1000h

Energieeffizienzklasse	A+
------------------------	----

## LOGISTISCHE DATEN

Lagertemperaturbereich	-20...+85 °C
------------------------	--------------



## Daten gemäß der Verordnung zur Energieverbrauchskennzeichnung EU 2019/2015





Ähnliche Farbtemperatur	SINGLE_VALUE
-------------------------	--------------

## ZUSÄTZLICHE PRODUKTINFORMATIONEN

- Installation by qualified electrician only.
- Please see the relevant application guides and instructions sheets for more detailed safety and mounting information. Additional information is available on request.
- The module / light engine has to be mounted to a proper heat sink in order to ensure that the maximum rated temperature at the  $T_c$  point will not be exceeded.
- For safety reasons the LED light engine must not be operated if the housing is damaged.
- Complies with IEC/EN 62031
- Complies with IEC/EN 61547
- Complies with IEC/EN 61000-3-2
- Complies with EN 55015, CISPR 15
- Complies with IEC/EN 62717
- Suitable only for operation with line voltage.
- Parallel connection is mandatory for safe electrical operation. Serial connection of LED modules is strongly discouraged. Unbalanced voltage drop in serial connection can cause hazardous overload and damage the LED module.
- Conducting paths on the circuit board must not be damaged or destroyed during installation.
- Suitable for luminaires of protection class I, grounding is mandatory to comply with safety standards.
- When used in a luminaire of protection class II compliance with the required safety standards has to be ensured by the luminaire manufacturer.
- This LED module is not recommended to be used in rooms with fast moving parts as the light modulation can cause stroboscopic effects.
- This LED module might interfere with displays and cameras due to modulation.
- The LED module itself and all its components must not be stressed mechanically.
- For optimal cooling a thermal interface material should be applied between LED module and heat sink.
- It is highly recommended to use a thermal interface material (TIM). The TIM needs to enable adequate heat transfer, during installation it has to be taken care not to create air inclusions between surfaces. For this purpose it is recommended to use a heat sink with even and clean surfaces.
- The module must not be attached to wood or other flammable materials.
- Protect against splashes!
- The module, as manufactured, has no inherent protection against corrosion. It is the user's responsibility to provide suitable protection against corrosive agents, such as moisture, condensation and other harmful elements.

## DOWNLOADS

DOWNLOADS	
	Certificates 664159_ENEC VDE Certificate: PL Cube AC G3
	Certificates 664150_CB VDE Certificate: PL Cube AC G3
	Declarations of conformity 664153_EC Declaration of Conformity: PL Cube AC G3

DOWNLOADS	
	CAD data 664804_CAD Data IGES: PrevaLED Cube AC G3
	CAD data 664806_CAD Datei Parasolid: PrevaLED Cube AC G3
	CAD data 664805_CAD Datei STEP: PrevaLED Cube AC G3
	CAD data 3-dim 664157_CAD Data 3D PDF: PL Cube AC G3
	Advertisements 673352_App Guide PrevaLED Cube AC G3 (GB)

**VERPACKUNGSMFORMATIONEN**

EAN	Verpackungseinheit (Stück pro Einheit)	Abmessungen (Länge x Breite x Höhe)	Bruttogewicht	Volumen
4052899952690	Unverpackt 1		59.40 g	
4052899953888	Versandschachtel 20	481 mm x 393 mm x 51 mm	1466.00 g	9.64 dm <sup>3</sup>

Die genannten Produktnummern beschreiben die kleinste bestellbare Mengeneinheit. Eine Versandeinheit kann mehrere Einzelprodukte beinhalten. Als Bestellmenge verwenden Sie bitte das Ein- oder Mehrfache einer Versandeinheit.

**Referenzen / Verweise**

- Mehr Information zur mehrstufigen Garantie und die gesamten Garantiebedingungen finden Sie im Internet unter [www.ledvance.de/systemgarantie](http://www.ledvance.de/systemgarantie)

**Haftungsausschluss**

Änderungen und Irrtümer vorbehalten. Vergewissern Sie sich, dass Sie immer den neuesten Stand verwenden.